

Town of Blue Mountains
 Planning and Development Services
Accepted For Construction
Pre-Service Only

AFC Drawings are only valid as part and upon execution of a Pre-Service Agreement

signature _____ date 15-MAR-2023

1. THIS DRAWING IS THE EXCLUSIVE PROPERTY OF C.F. CROZIER & ASSOCIATES INC. AND THE REPRODUCTION OF ANY PART WITHOUT PRIOR WRITTEN CONSENT OF THIS OFFICE IS STRICTLY PROHIBITED.
2. THE CONTRACTOR SHALL VERIFY ALL DIMENSIONS, LEVELS, AND DATUMS ON SITE AND REPORT ANY DISCREPANCIES OR OMISSIONS TO THIS OFFICE PRIOR TO CONSTRUCTION.
3. THIS DRAWING IS TO BE READ AND UNDERSTOOD IN CONJUNCTION WITH ALL OTHER PLANS AND DOCUMENTS APPLICABLE TO THIS PROJECT.
4. DO NOT SCALE THE DRAWINGS.
5. ALL EXISTING UNDERGROUND UTILITIES TO BE VERIFIED IN THE FIELD BY THE CONTRACTOR PRIOR TO CONSTRUCTION.

TEMPORARY BENCHMARKS
 TBM#1 - ELEVATIONS HEREON ARE GEODETIC AND ARE REFERRED TO A SPIKE IN HYDRO POLE ON GREY ROAD 19 SOUTH OF CRAIGLEITH ROAD HAVING AN ELEVATION OF 222.88 METRES.

TOPOGRAPHIC SURVEY COMPLETED BY ZUBEK, EMO, PATTEN AND THOMSEN LTD. O.L.S., DATED MARCH 2006.

No.	ISSUE	DATE: MM/DD/YYYY
0	ISSUED FOR 1st SUBMISSION	10/05/2018
1	ISSUED FOR 2nd SUBMISSION	09/17/2020
2	ISSUED FOR 3rd SUBMISSION	05/14/2021
3	ISSUED FOR 4th SUBMISSION	03/23/2022
4	ISSUED FOR 5th SUBMISSION (PARTIAL)	10/26/2022
5	ISSUED FOR 5th SUBMISSION	11/23/2022
6	ISSUED FOR 6th SUBMISSION (SWMFS ONLY)	03/29/2023
7	ISSUED FOR 6th SUBMISSION	04/20/2023

This Drawing is For
INFORMATION ONLY
 This Drawing should not be redistributed beyond the intended recipient

- NOTE:**
1. SWM FACILITY TO BE CONSTRUCTED IN ACCORDANCE WITH THE GEOTECHNICAL REPORT AND CONSTRUCTION IS TO BE OVERSEEN BY THE GEOTECHNICAL CONSULTANT.
 2. SWM FACILITY BERM MATERIAL TO BE TESTED BY GEOTECHNICAL ENGINEER PRIOR TO CONSTRUCTION.
 3. STORMWATER MANAGEMENT TO BE IMPLEMENTED IN CONJUNCTION WITH DOWNSTREAM REGIONAL DRAINAGE IMPROVEMENTS. REFER TO REGIONAL DRAINAGE IMPROVEMENT DRAWINGS UNDER SEPARATE COVER.
 4. TURTLE OVERWINTERING AREA TO BE CONSTRUCTED WITH SOFT, MUDDY SUBSTRATES, PREFERABLY HIGH IN ORGANIC CONTENT.

- POND CONSTRUCTION NOTES:**
1. WETPOND TO BE FINISHED WITH TOPSOIL AQUATIC PLANTINGS PER LANDSCAPE ARCHITECT.
 2. MATERIAL FOR POND BERM LINER CONSTRUCTION TO BE APPROVED AND CERTIFIED BY GEOTECHNICAL CONSULTANT TO ENSURE ADEQUATE STRUCTURAL STRENGTH AND PERMEABILITY. REFER TO GEOTECHNICAL REPORT FOR RECOMMENDATIONS.
 3. REFER TO GEOTECHNICAL REPORT FOR TEST PIT INFORMATION.

Project
**PARKBRIDGE CRAIGLEITH
 THE TOWN OF THE BLUE MOUNTAINS**

Drawing
**STORMWATER MANAGEMENT FACILITY 1
 (UPPER POND) PLAN**

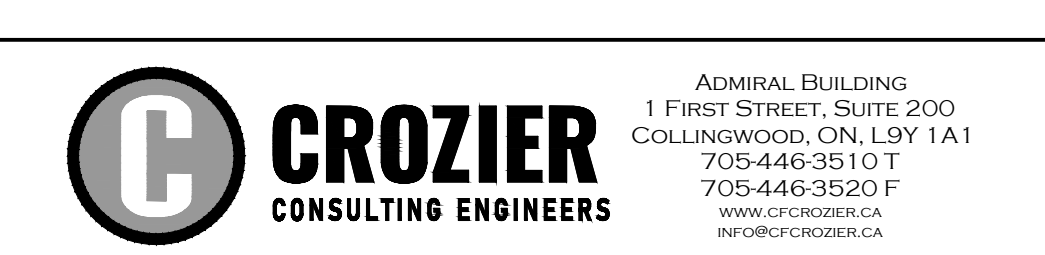

Drawn By L.W. Design By L.W. Project **1046-4031**
 Check By R.W. Check By J.P. Scale 1:300 Drawing **C108.A**

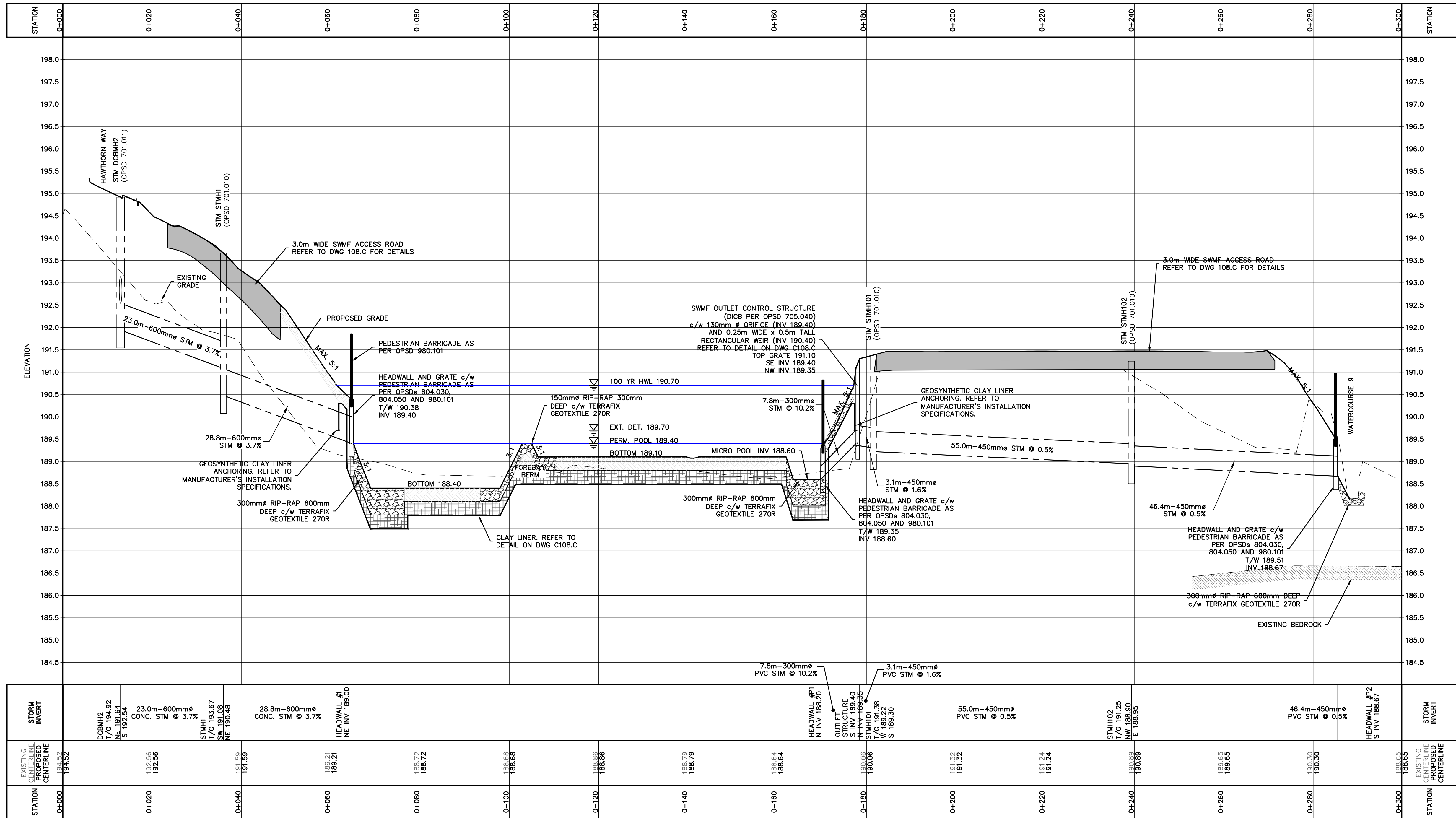

Town of Blue Mountains
 Planning and Development Services
**Accepted For Construction
 Pre-Servicing Only**

APC Drawings are only valid as part and upon execution of a
 Pre-servicing Agreement

signature *[Signature]* date *15-March-2023*

- THIS DRAWING IS THE EXCLUSIVE PROPERTY OF C.F. CROZIER & ASSOCIATES INC. AND THE REPRODUCTION OF ANY PART WITHOUT PRIOR WRITTEN CONSENT OF THIS OFFICE IS STRICTLY PROHIBITED.
- THE CONTRACTOR SHALL VERIFY ALL DIMENSIONS, LEVELS, AND DATUMS ON SITE AND REPORT ANY DISCREPANCIES OR OMISSIONS TO THIS OFFICE PRIOR TO CONSTRUCTION.
- THIS DRAWING IS TO BE READ AND UNDERSTOOD IN CONJUNCTION WITH ALL OTHER PLANS AND DOCUMENTS APPLICABLE TO THIS PROJECT.
- DO NOT SCALE THE DRAWINGS.
- ALL EXISTING UNDERGROUND UTILITIES TO BE VERIFIED IN THE FIELD BY THE CONTRACTOR PRIOR TO CONSTRUCTION.

TEMPORARY BENCHMARKS
 TBM #1 - ELEVATIONS HEREON ARE GEODETIC AND ARE REFERRED TO A SPIKE IN HYDRO POLE ON GREY ROAD 19 SOUTH OF CRAIGLEITH ROAD HAVING AN ELEVATION OF 222.88 METRES.

TOPOGRAPHIC SURVEY COMPLETED BY ZUBEK, EMO, PATTEN AND THOMSEN LTD. O.L.S., DATED MARCH 2006.

No.	ISSUE	DATE: MM/DD/YYYY
0	ISSUED FOR 1st SUBMISSION	10/05/2018
1	ISSUED FOR 2nd SUBMISSION	09/17/2020
2	ISSUED FOR 3rd SUBMISSION	05/14/2021
3	ISSUED FOR 4th SUBMISSION	03/23/2022
4	ISSUED FOR 5th SUBMISSION (PARTIAL)	10/26/2022
5	ISSUED FOR 5th SUBMISSION	11/23/2022
6	ISSUED FOR 6th SUBMISSION (SWMFs ONLY)	03/29/2023
7	ISSUED FOR 6th SUBMISSION	04/20/2023

This Drawing is For
**INFORMATION
 ONLY**
 This Drawing should not be
 redistributed beyond the
 intended recipient

PARKBRIDGE CRAIGLEITH
 THE TOWN OF THE BLUE MOUNTAINS

STORMWATER MANAGEMENT FACILITY 1
 (UPPER POND) CROSS SECTIONS

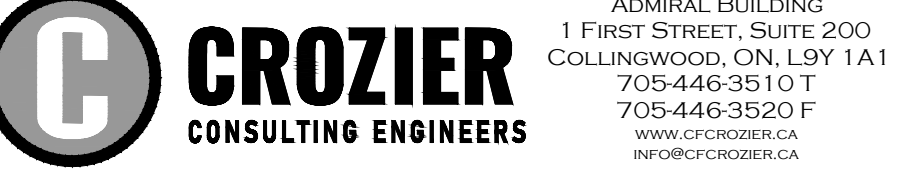

ADMIRAL BUILDING
 1 FIRST STREET, SUITE 200
 COLLINGWOOD, ON, L9Y 1A1
 705-446-3510 T
 705-446-3520 F
 WWW.CFCROZIER.CA
 INFO@CFCROZIER.CA

Drawn By: L.W. Design By: L.W. Project: 1046-4031
 Check By: R.W. Check By: J.P. Scale: V=1:50 Drawing: C108.B
 H=1:500

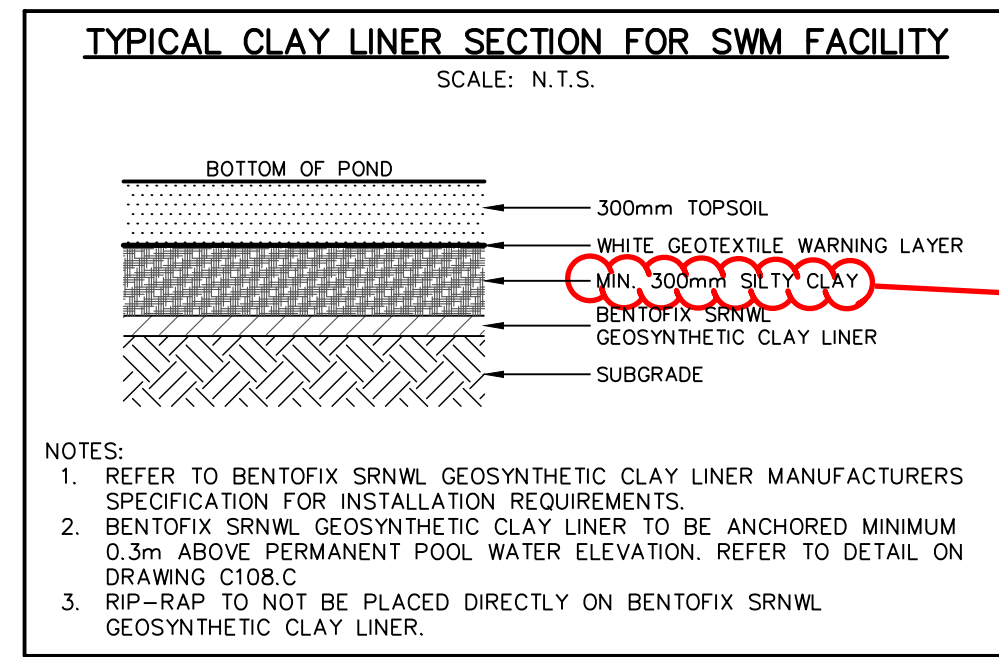
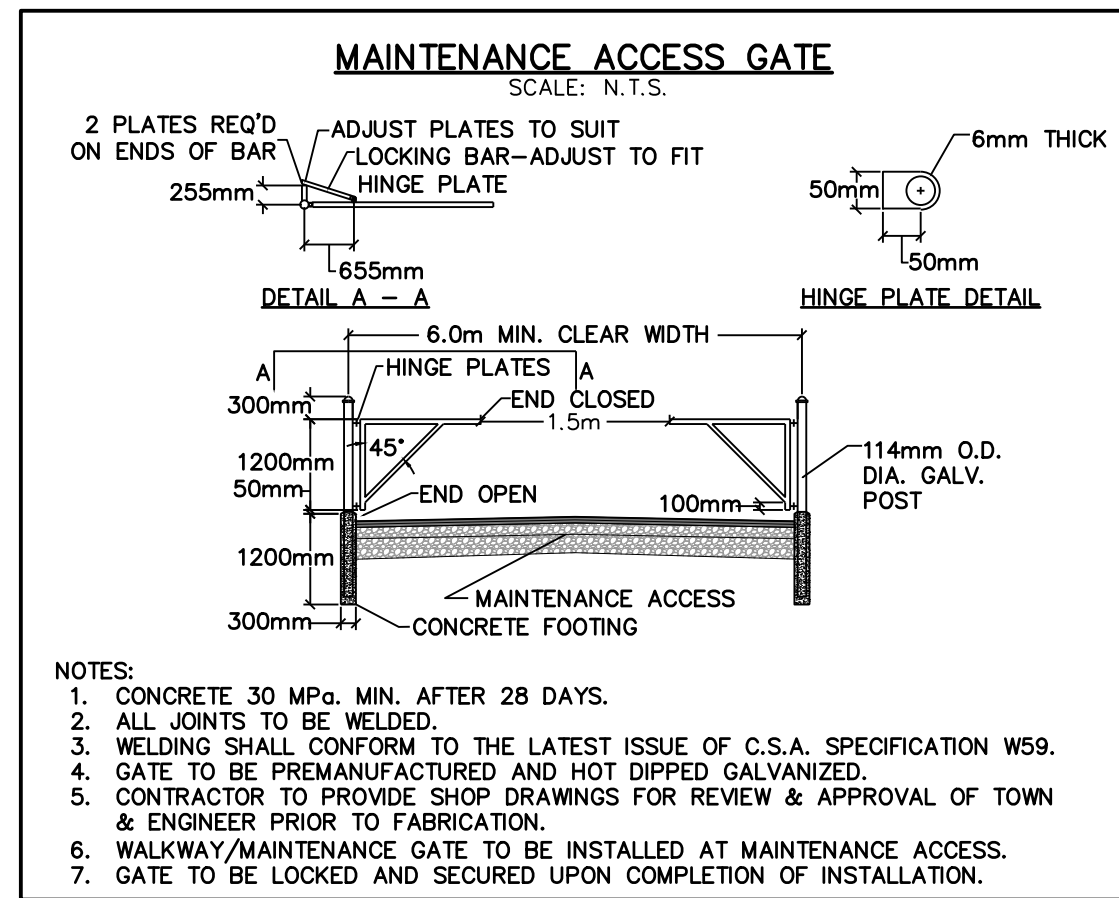

"Material should be compacted to minimum 95% SPMDD. Two lifts 150 mm thick" per GEI, Geotechnical Consultant

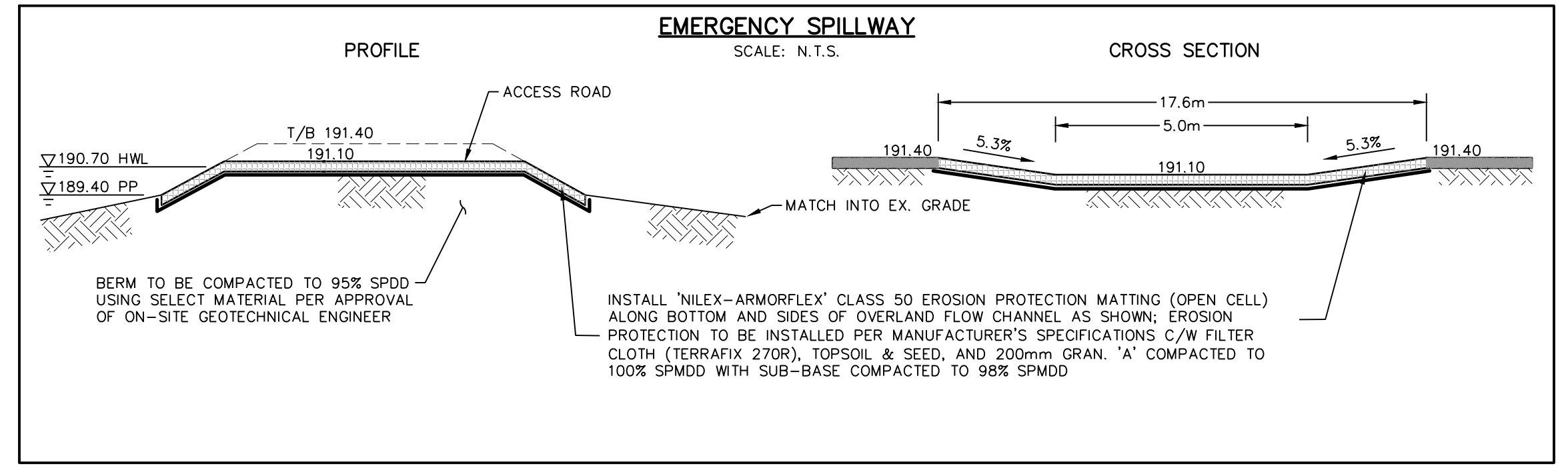

WARNING

CAUTION: POND CONTAINS DEEP WATER. CONDITIONS IN THE STORMWATER POND CAN CHANGE RAPIDLY INCLUDING FLUCTUATING WATER LEVELS AND THIN ICE. BOATING, SWIMMING, FISHING OR SKATING STRICTLY PROHIBITED.

THE TOWN OF THE BLUE MOUNTAINS

STORMWATER MANAGEMENT FACILITY #1 WARNING SIGN
SCALE: N.T.S.

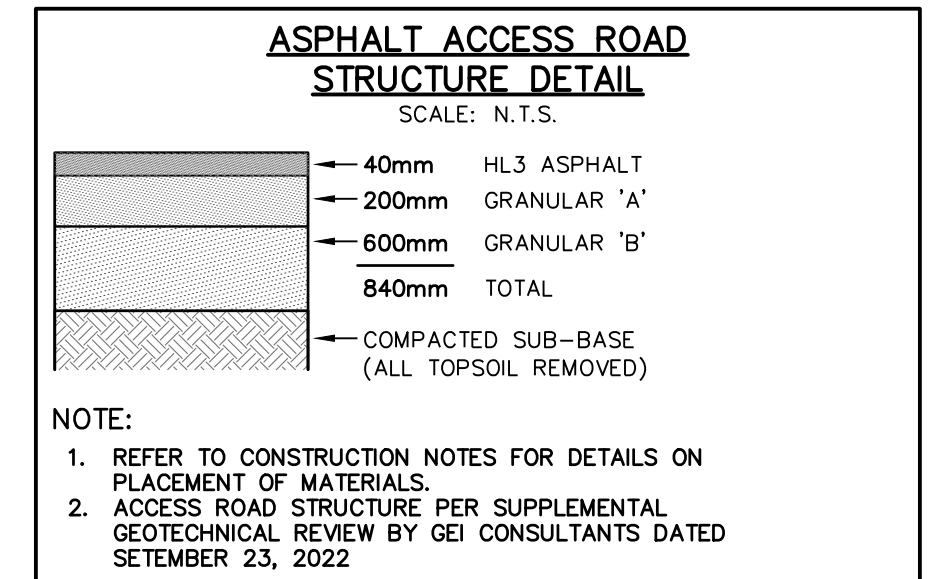
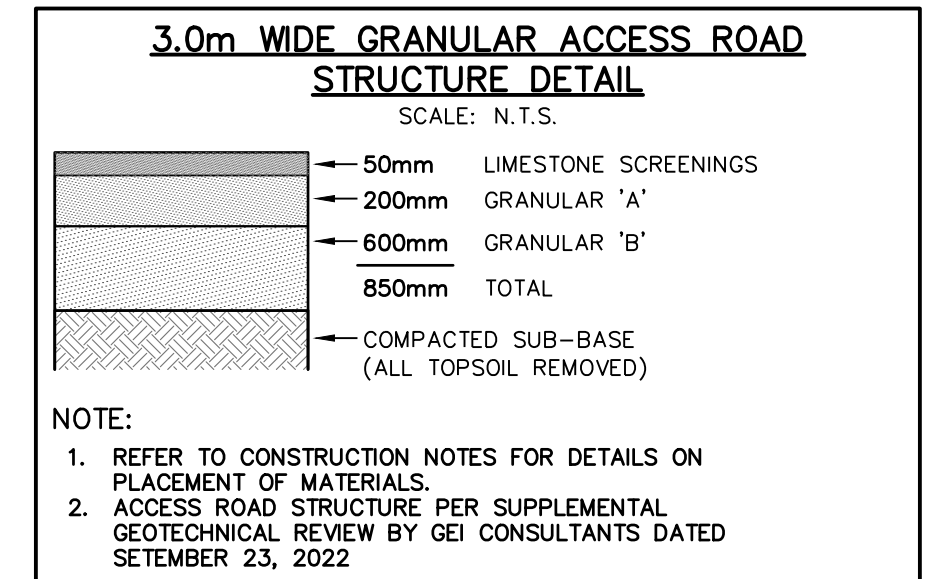
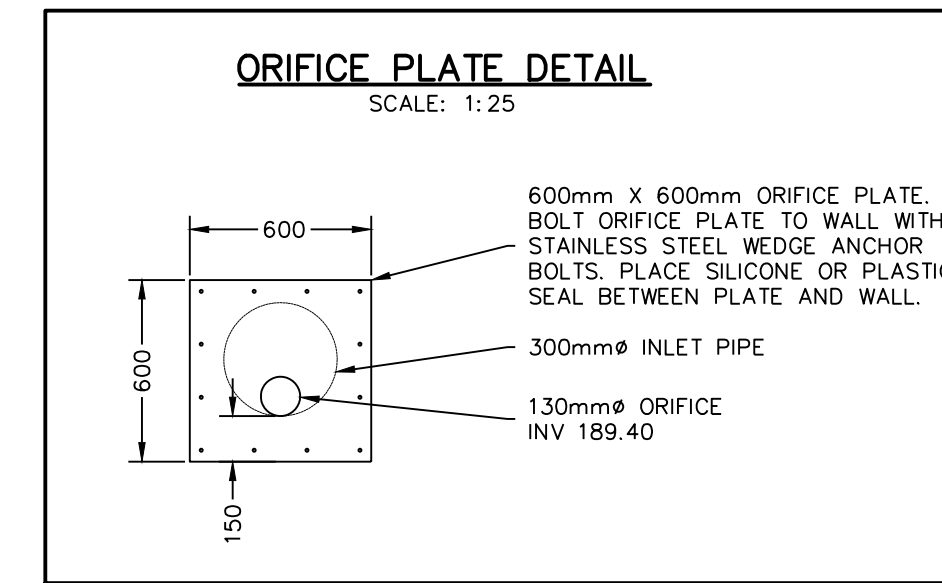
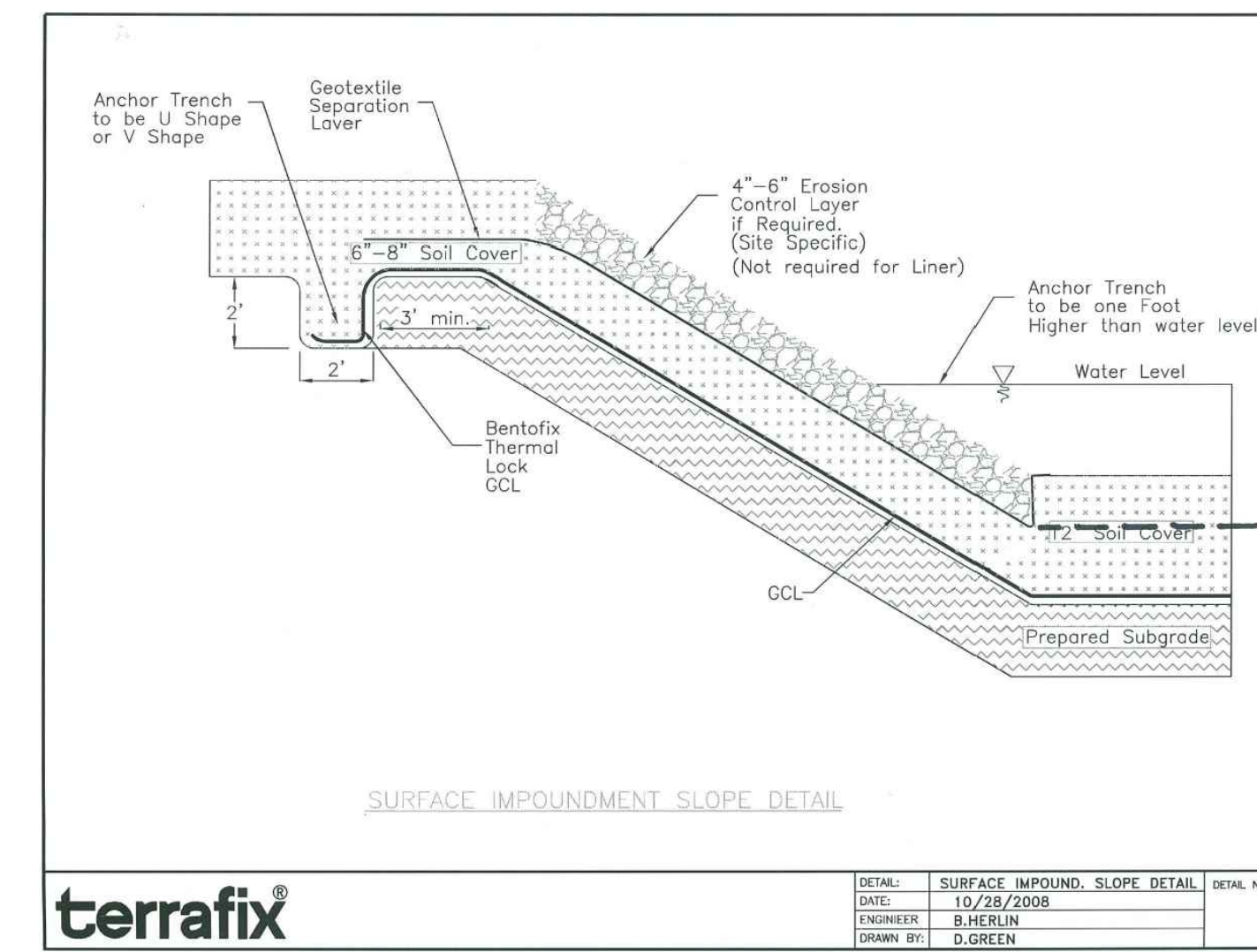

Town of Blue Mountains
Planning and Development Services
Accepted For Construction
Pre-Servicing Only

APC Drawings are only valid as part and upon execution of a Pre-servicing Agreement

signature: [Signature] date: 15-May-2023

- THIS DRAWING IS THE EXCLUSIVE PROPERTY OF C.F. CROZIER & ASSOCIATES INC. AND THE REPRODUCTION OF ANY PART WITHOUT PRIOR WRITTEN CONSENT OF THIS OFFICE IS STRICTLY PROHIBITED.
- THE CONTRACTOR SHALL VERIFY ALL DIMENSIONS, LEVELS, AND DATUMS ON SITE AND REPORT ANY DISCREPANCIES OR OMISSIONS TO THIS OFFICE PRIOR TO CONSTRUCTION.
- THIS DRAWING IS TO BE READ AND UNDERSTOOD IN CONJUNCTION WITH ALL OTHER PLANS AND DOCUMENTS APPLICABLE TO THIS PROJECT.
- DO NOT SCALE THE DRAWINGS.
- ALL EXISTING UNDERGROUND UTILITIES TO BE VERIFIED IN THE FIELD BY THE CONTRACTOR PRIOR TO CONSTRUCTION.

TEMPORARY BENCHMARKS

TBM#1 - ELEVATIONS HEREON ARE GEODETIC AND ARE REFERRED TO A SPIKE IN HYDRO POLE ON GREY ROAD 19 SOUTH OF CRAIGLEITH ROAD HAVING AN ELEVATION OF 222.88 METRES.

TOPOGRAPHIC SURVEY COMPLETED BY ZUBEK, EMO, PATTEN AND THOMSEN LTD. O.L.S., DATED MARCH 2006.

No.	ISSUE	DATE: MM/DD/YYYY
0	ISSUED FOR 1st SUBMISSION	10/05/2018
1	ISSUED FOR 2nd SUBMISSION	09/17/2020
2	ISSUED FOR 3rd SUBMISSION	05/14/2021
3	ISSUED FOR 4th SUBMISSION	03/23/2022
4	ISSUED FOR 5th SUBMISSION (PARTIAL)	10/26/2022
5	ISSUED FOR 5th SUBMISSION	11/23/2022
6	ISSUED FOR 6th SUBMISSION (SWMFs ONLY)	03/29/2023
7	ISSUED FOR 6th SUBMISSION	04/20/2023

This Drawing is For
INFORMATION ONLY
This Drawing should not be redistributed beyond the intended recipient

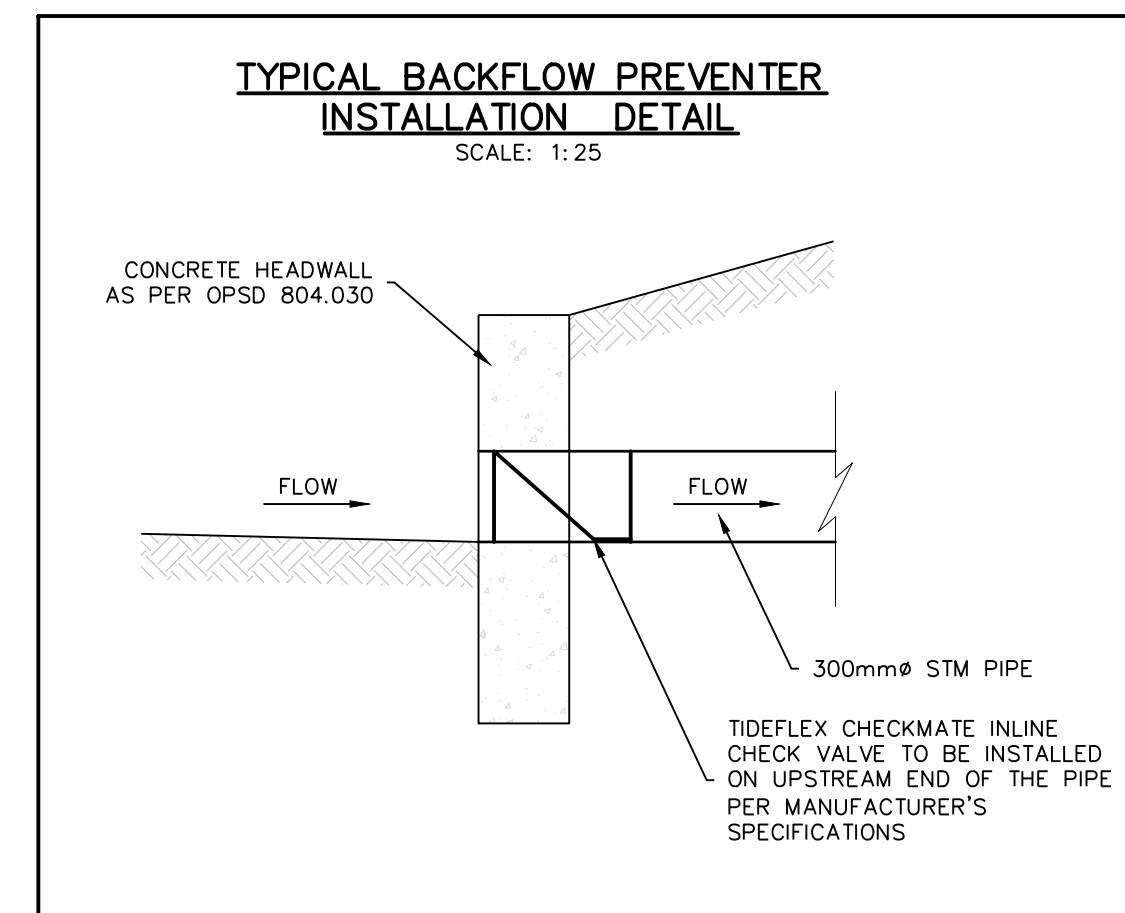
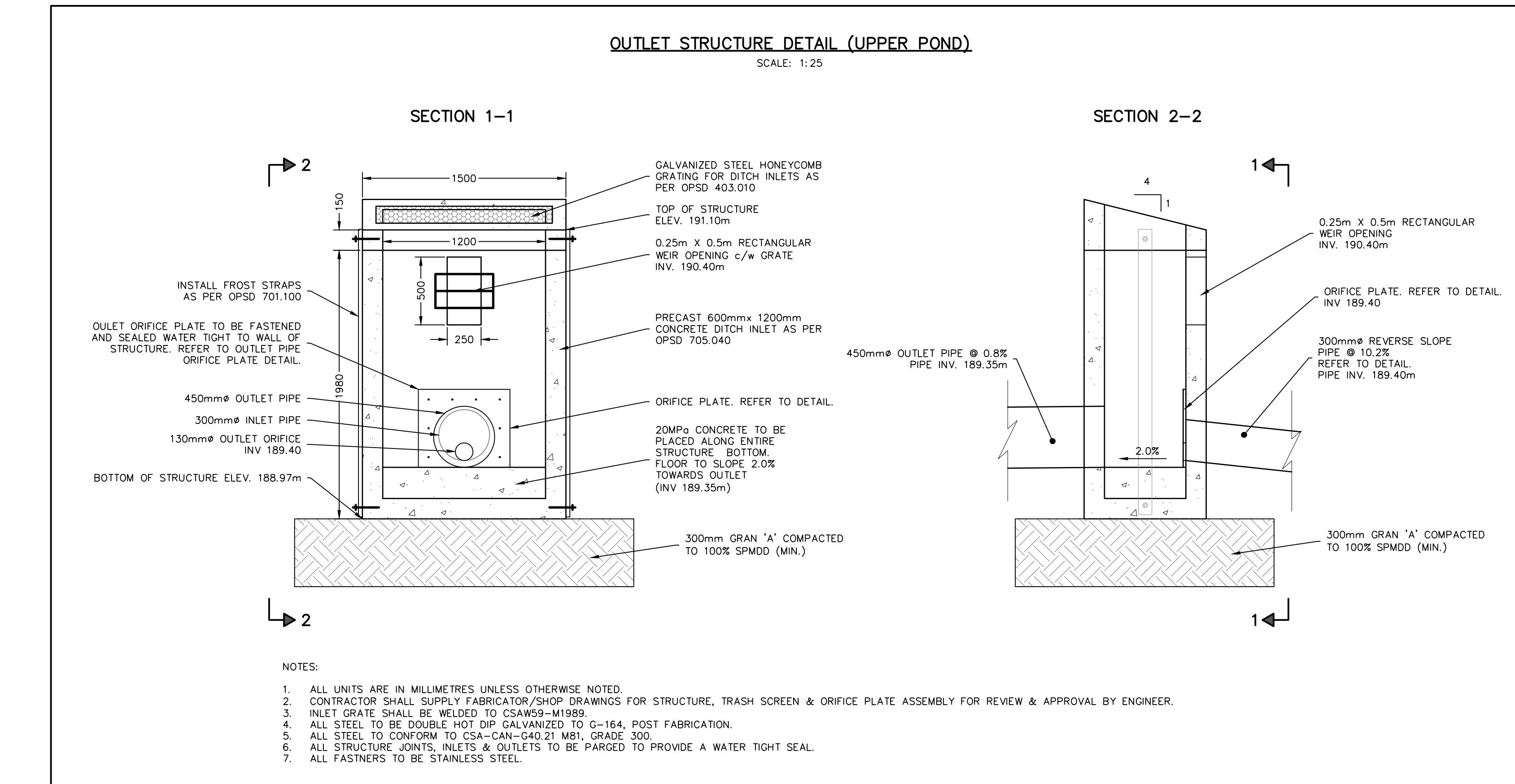

Project
PARKBRIDGE CRAIGLEITH
THE TOWN OF THE BLUE MOUNTAINS

Drawing
STORMWATER MANAGEMENT FACILITY 1 (UPPER POND) DETAILS

Drawn By: L.W. Design By: L.W. Project: **1046-4031**
Check By: R.W. Check By: J.P. Scale: AS SHOWN Drawing: **C108.C**

ADMIRAL BUILDING
1 FIRST STREET, SUITE 200
COLLINGWOOD, ON, L9Y 1A1
705-446-3510 T
705-446-3520 F
WWW.CFCROZIER.CA
INFO@CFCROZIER.CA

CROZIER
CONSULTING ENGINEERS

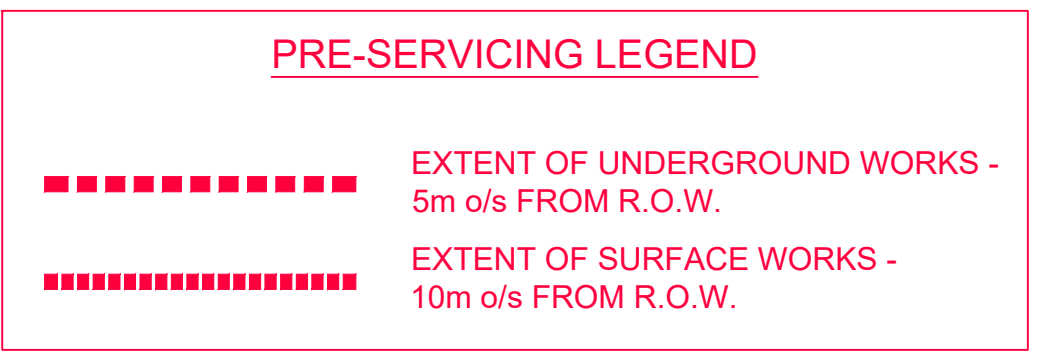
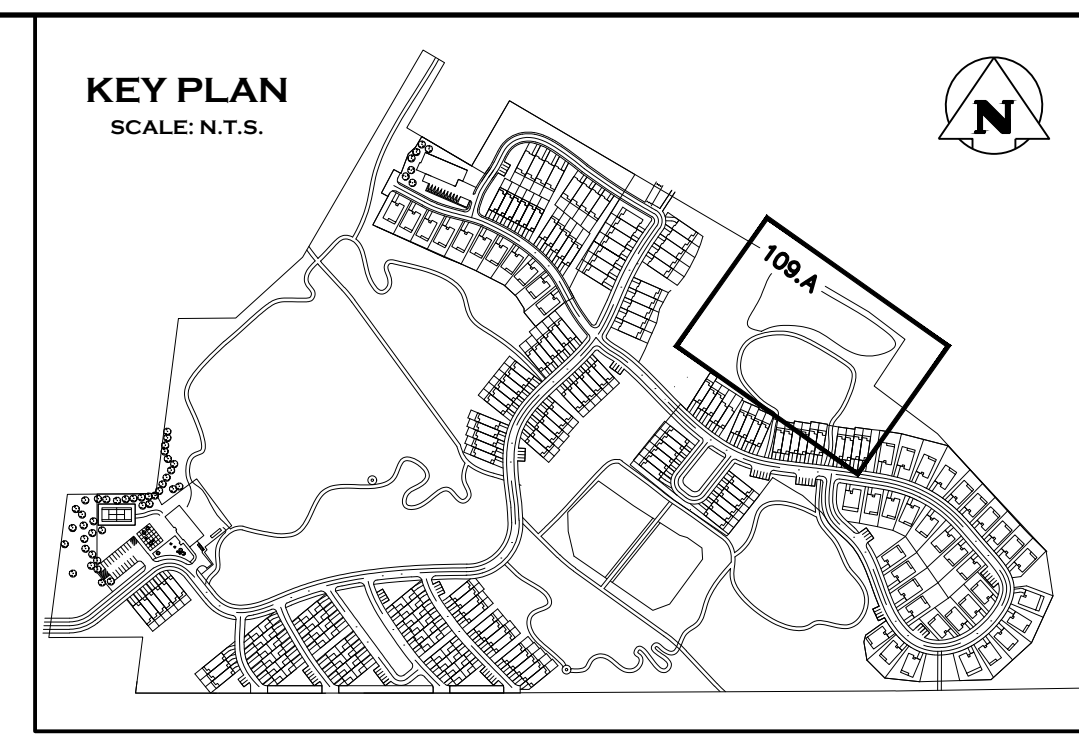
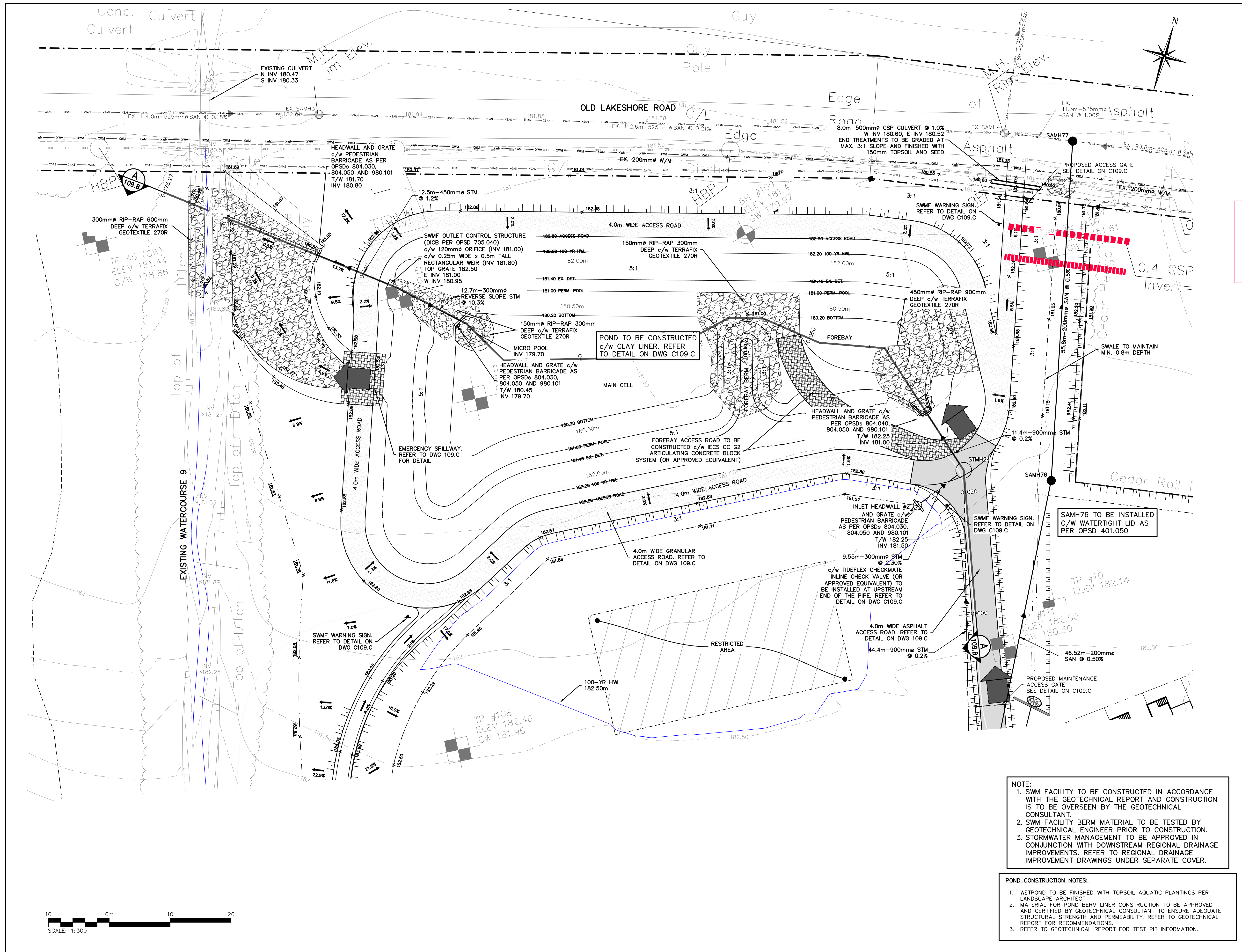

Town of Blue Mountains
Planning and Development Services
Approved For Construction Pre-Servicing Only
APC Drawings are only valid as part and upon execution of a Pre-Servicing Agreement
signature: *[Signature]* date: *15-Mar-2023*

- THIS DRAWING IS THE EXCLUSIVE PROPERTY OF C.F. CROZIER & ASSOCIATES INC. AND THE REPRODUCTION OF ANY PART WITHOUT PRIOR WRITTEN CONSENT OF THIS OFFICE IS STRICTLY PROHIBITED.
- THE CONTRACTOR SHALL VERIFY ALL DIMENSIONS, LEVELS, AND DATUMS ON SITE AND REPORT ANY DISCREPANCIES OR OMISSIONS TO THIS OFFICE PRIOR TO CONSTRUCTION.
- THIS DRAWING IS TO BE READ AND UNDERSTOOD IN CONJUNCTION WITH ALL OTHER PLANS AND DOCUMENTS APPLICABLE TO THIS PROJECT.
- DO NOT SCALE THE DRAWINGS.
- ALL EXISTING UNDERGROUND UTILITIES TO BE VERIFIED IN THE FIELD BY THE CONTRACTOR PRIOR TO CONSTRUCTION.

TEMPORARY BENCHMARKS
Benchmarks #1 - ELEVATIONS HEREON ARE GEODETIC AND ARE REFERRED TO A SPIKE IN HYDRO POLE ON GREY ROAD 19 SOUTH OF CRAIGLEITH ROAD HAVING AN ELEVATION OF 222.88 METRES.

TOPOGRAPHIC SURVEY COMPLETED BY ZUBEK, EMO, PATTEN AND THOMSEN LTD. O.L.S., DATED MARCH 2006.

No.	ISSUE	DATE: MM/DD/YYYY
0	ISSUED FOR 1st SUBMISSION	10/05/2018
1	ISSUED FOR 2nd SUBMISSION	09/17/2020
2	ISSUED FOR 3rd SUBMISSION	05/14/2021
3	ISSUED FOR 4th SUBMISSION	03/23/2022
4	ISSUED FOR 5th SUBMISSION (PARTIAL)	10/26/2022
5	ISSUED FOR 5th SUBMISSION	11/23/2022
6	ISSUED FOR 6th SUBMISSION (SWMFS ONLY)	03/29/2023
7	ISSUED FOR 6th SUBMISSION	04/20/2023

This Drawing is For INFORMATION ONLY
This Drawing should not be redistributed beyond the intended recipient

NOTE:
1. SWM FACILITY TO BE CONSTRUCTED IN ACCORDANCE WITH THE GEOTECHNICAL REPORT AND CONSTRUCTION IS TO BE OVERSEEN BY THE GEOTECHNICAL CONSULTANT.
2. SWM FACILITY BERM MATERIAL TO BE TESTED BY GEOTECHNICAL ENGINEER PRIOR TO CONSTRUCTION.
3. STORMWATER MANAGEMENT TO BE APPROVED IN CONJUNCTION WITH DOWNSTREAM REGIONAL DRAINAGE IMPROVEMENTS. REFER TO REGIONAL DRAINAGE IMPROVEMENT DRAWINGS UNDER SEPARATE COVER.

POND CONSTRUCTION NOTES:
1. WETPOND TO BE FINISHED WITH TOPSOIL AQUATIC PLANTINGS PER LANDSCAPE ARCHITECT.
2. MATERIAL FOR POND BERM LINER CONSTRUCTION TO BE APPROVED AND CERTIFIED BY GEOTECHNICAL CONSULTANT TO ENSURE ADEQUATE STRUCTURAL STRENGTH AND PERMEABILITY. REFER TO GEOTECHNICAL REPORT FOR RECOMMENDATIONS.
3. REFER TO GEOTECHNICAL REPORT FOR TEST PIT INFORMATION.

Project
**PARKBRIDGE CRAIGLEITH
THE TOWN OF THE BLUE MOUNTAINS**

Drawing
**STORMWATER MANAGEMENT FACILITY 2
(LOWER POND) PLAN**

CROZIER
CONSULTING ENGINEERS
ADMIRAL BUILDING
1 FIRST STREET, SUITE 200
COLLINGWOOD, ON, L9Y 1A1
705-446-3510 T
705-446-3520 F
WWW.CROZIER.CA
INFO@CROZIER.CA

Drawn By: L.W. Design By: L.W. Project: **1046-4031**
Check By: R.W. Check By: J.P. Scale: 1:300 Drawing: **C109.A**



Town of Blue Mountains
 Planning and Development Services
**Accepted For Construction
 Pre-Service Only**

AFC Drawings are only valid as part and upon execution of a
 Pre-servicing Agreement

signature: *[Signature]* date: 18-04-2023

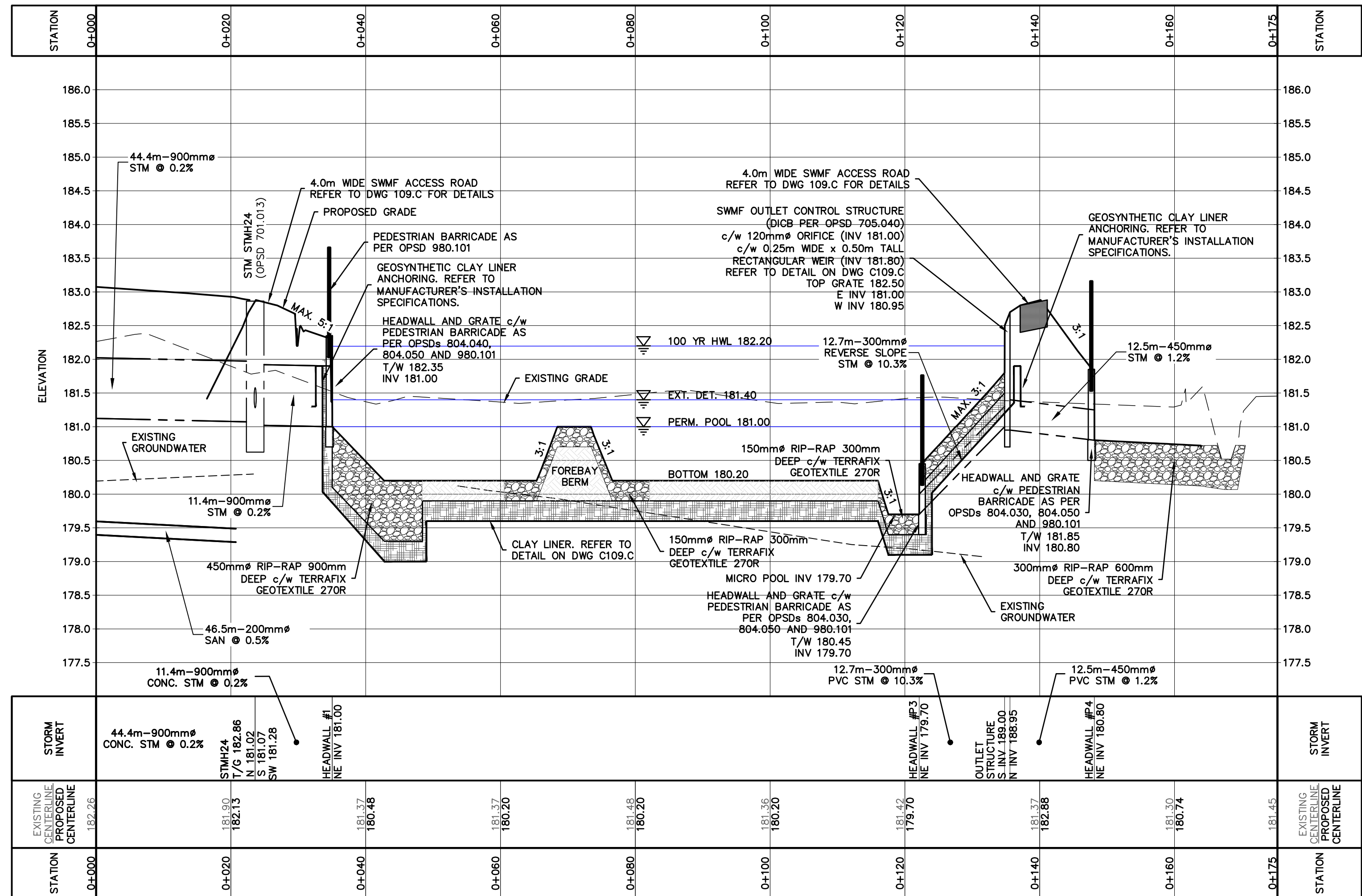

- THIS DRAWING IS THE EXCLUSIVE PROPERTY OF C.F. CROZIER & ASSOCIATES INC. AND THE REPRODUCTION OF ANY PART WITHOUT PRIOR WRITTEN CONSENT OF THIS OFFICE IS STRICTLY PROHIBITED.
- THE CONTRACTOR SHALL VERIFY ALL DIMENSIONS, LEVELS, AND DATUMS ON SITE AND REPORT ANY DISCREPANCIES OR OMISSIONS TO THIS OFFICE PRIOR TO CONSTRUCTION.
- THIS DRAWING IS TO BE READ AND UNDERSTOOD IN CONJUNCTION WITH ALL OTHER PLANS AND DOCUMENTS APPLICABLE TO THIS PROJECT.
- DO NOT SCALE THE DRAWINGS.
- ALL EXISTING UNDERGROUND UTILITIES TO BE VERIFIED IN THE FIELD BY THE CONTRACTOR PRIOR TO CONSTRUCTION.

TEMPORARY BENCHMARKS
 TBM#1 - ELEVATIONS HEREON ARE GEODETIC AND ARE REFERRED TO A SPIKE IN HYDRO POLE ON GREY ROAD 19 SOUTH OF CRAIGLEITH ROAD HAVING AN ELEVATION OF 222.88 METRES.

TOPOGRAPHIC SURVEY COMPLETED BY ZUBEK, EMO, PATTEN AND THOMSEN LTD. O.L.S., DATED MARCH 2006.

No.	ISSUE	DATE: MM/DD/YYYY
0	ISSUED FOR 1st SUBMISSION	10/05/2018
1	ISSUED FOR 2nd SUBMISSION	09/17/2020
2	ISSUED FOR 3rd SUBMISSION	05/14/2021
3	ISSUED FOR 4th SUBMISSION	03/23/2022
4	ISSUED FOR 5th SUBMISSION (PARTIAL)	10/26/2022
5	ISSUED FOR 5th SUBMISSION	11/23/2022
6	ISSUED FOR 6th SUBMISSION (SWMF ONLY)	03/29/2023
7	ISSUED FOR 6th SUBMISSION	04/20/2023

This Drawing is For
**INFORMATION
 ONLY**
 This Drawing should not be
 redistributed beyond the
 intended recipient

Project
**PARKBRIDGE CRAIGLEITH
 THE TOWN OF THE BLUE MOUNTAINS**

Drawing
**STORMWATER MANAGEMENT FACILITY 2
 (LOWER POND) CROSS SECTIONS**

CROZIER
 CONSULTING ENGINEERS

ADMIRAL BUILDING
 1 FIRST STREET, SUITE 200
 COLLINGWOOD, ON, L9Y 1A1
 705-446-3510 T
 705-446-3520 F
 WWW.CFCROZIER.CA
 INFO@CFCROZIER.CA

Drawn By: L.W. Design By: L.W. Project: **1046-4031**

Check By: R.W. Check By: J.P. Scale: AS SHOWN Drawing: **C109.B**

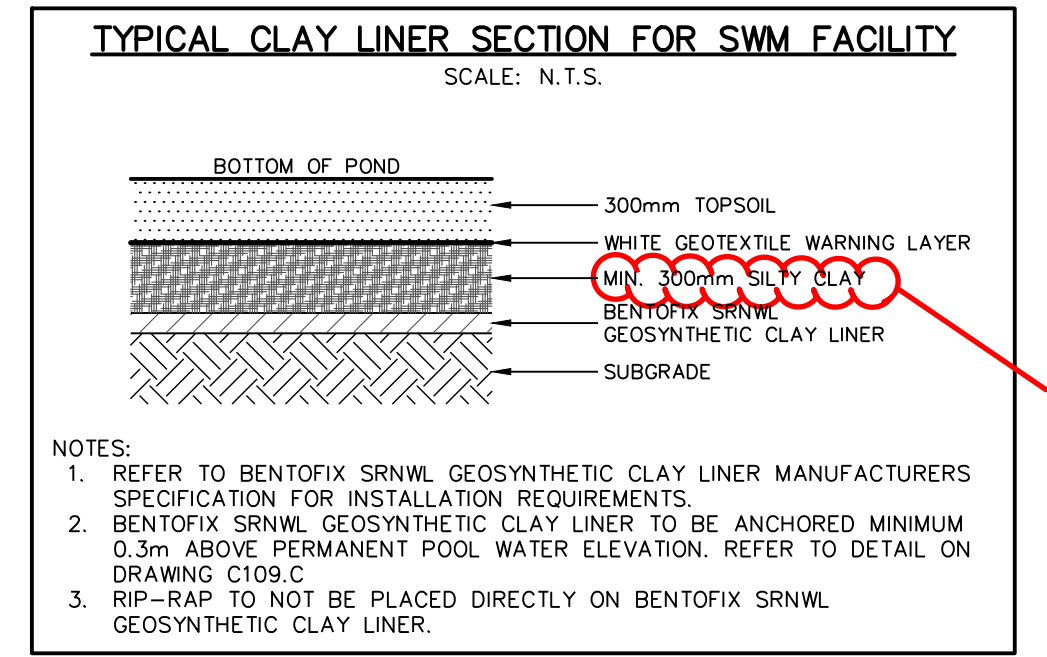
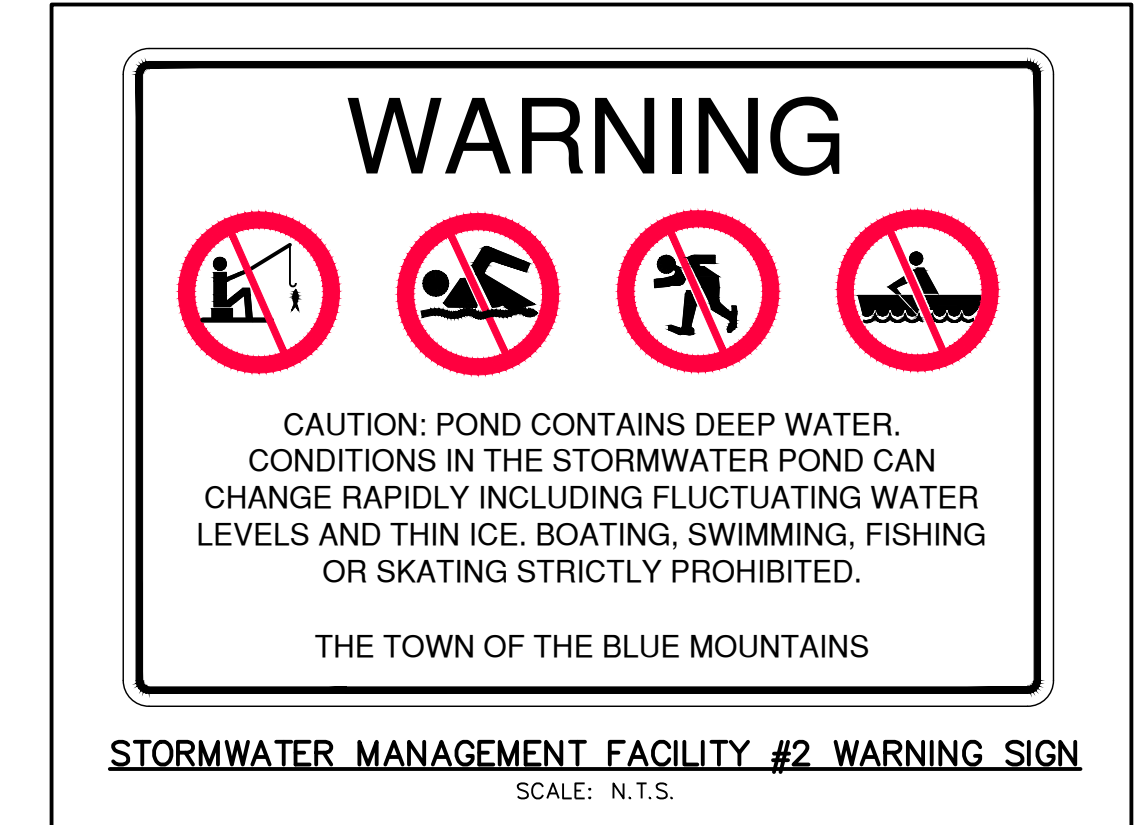
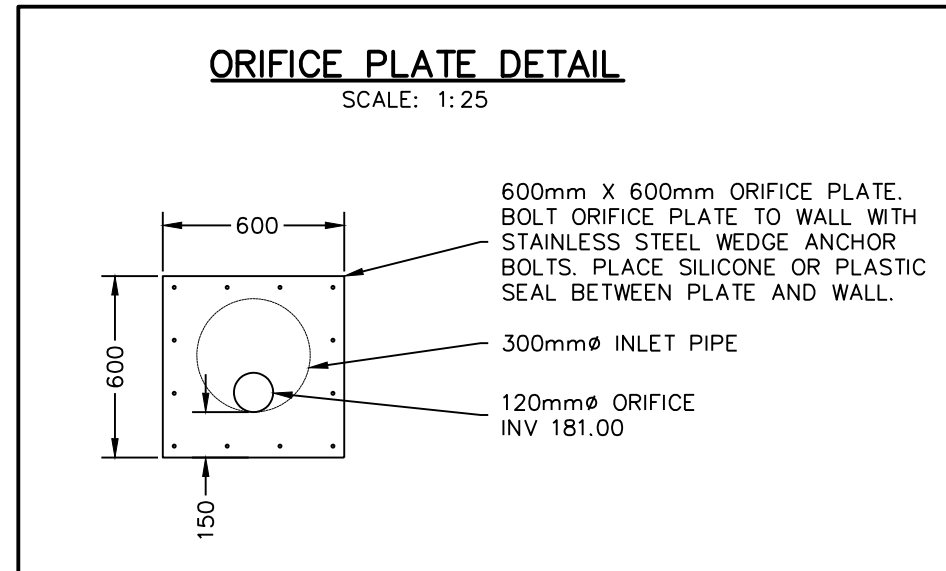
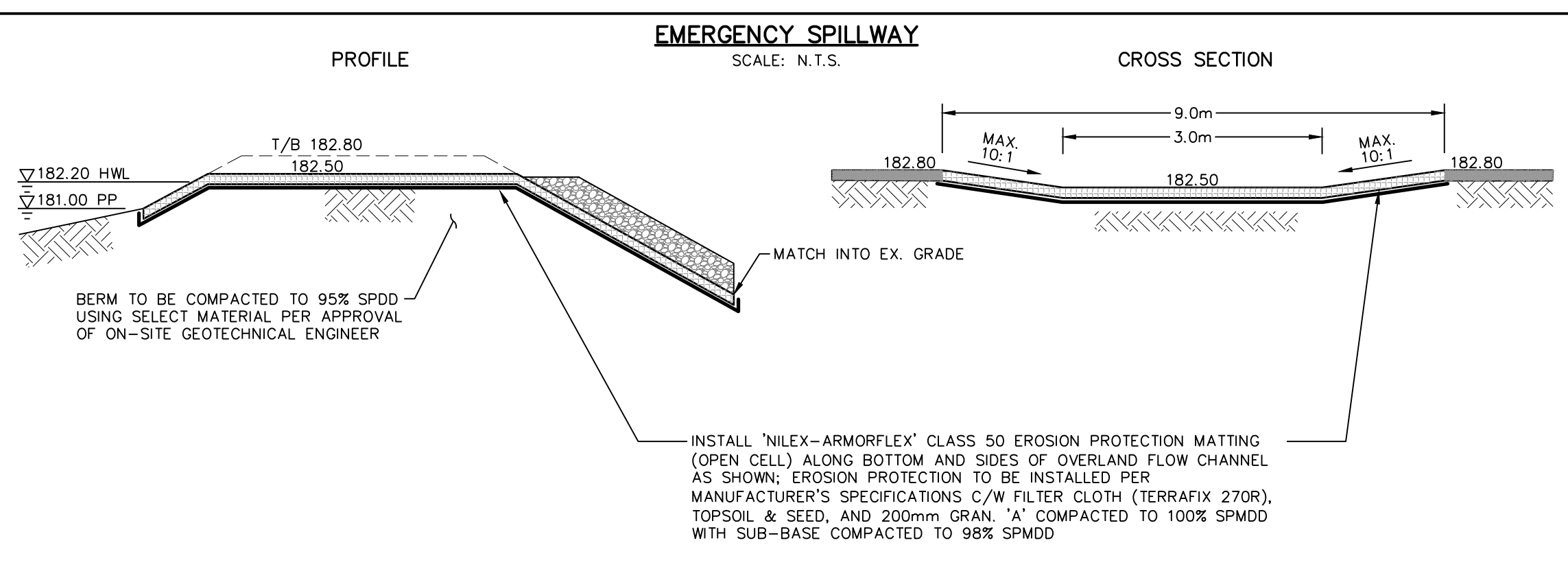
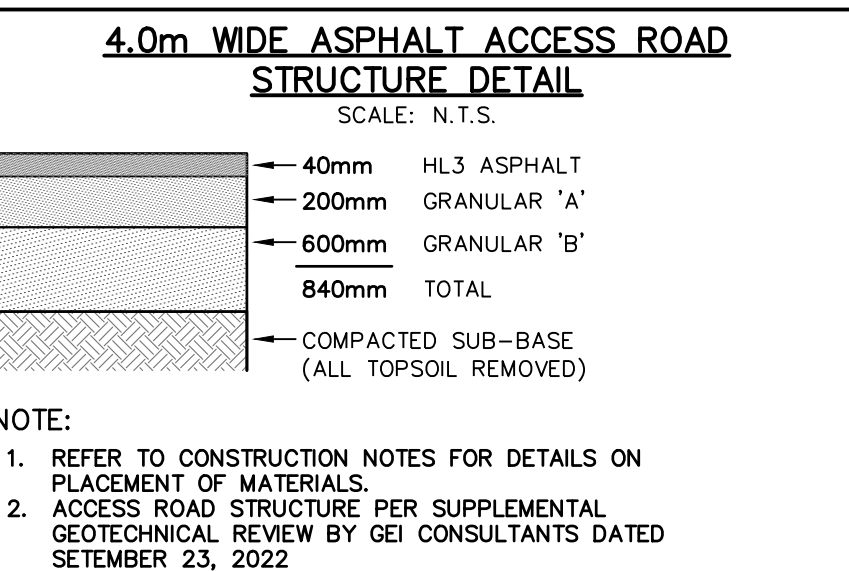
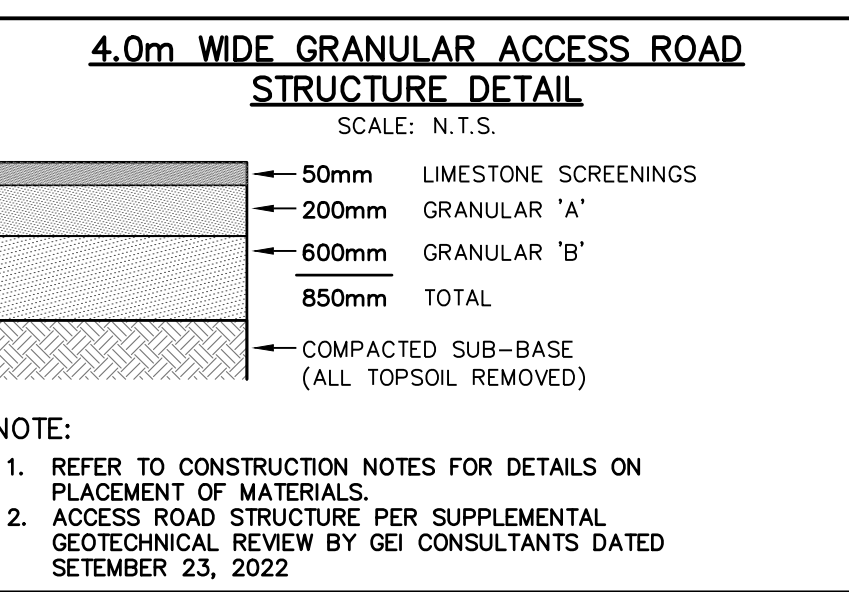
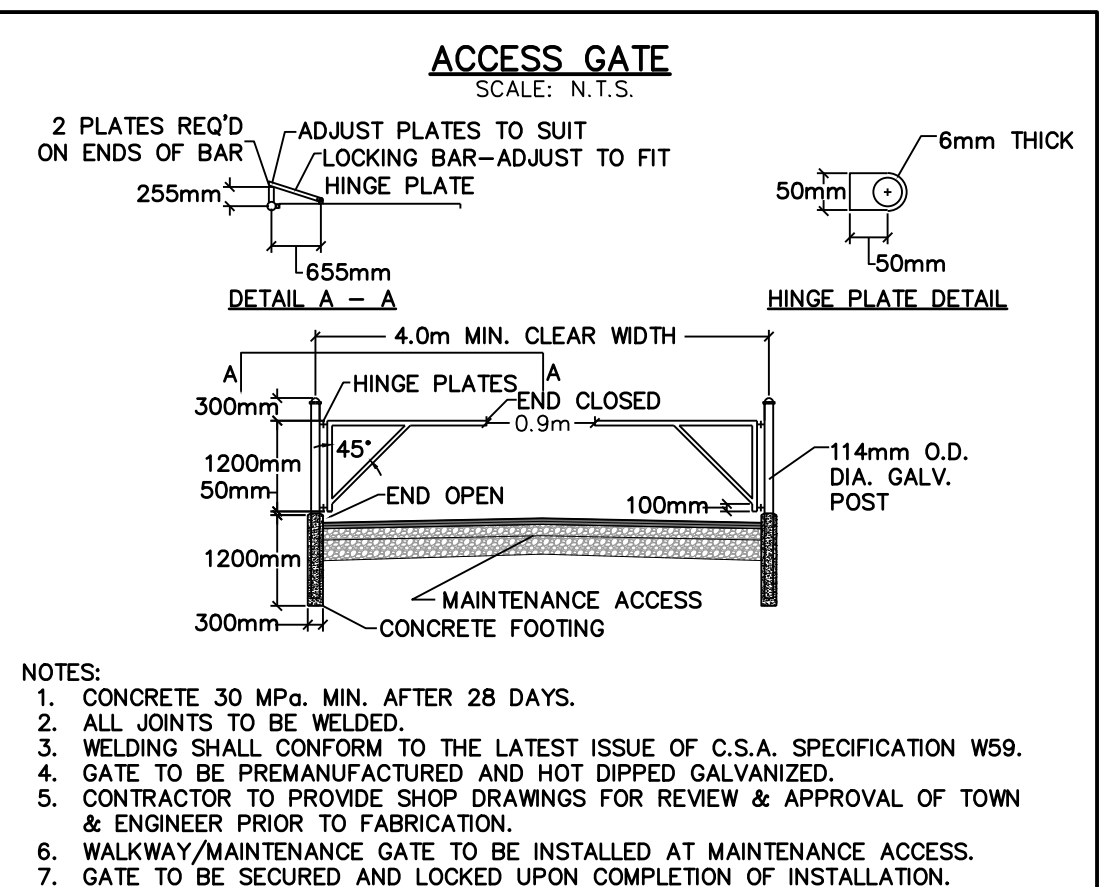
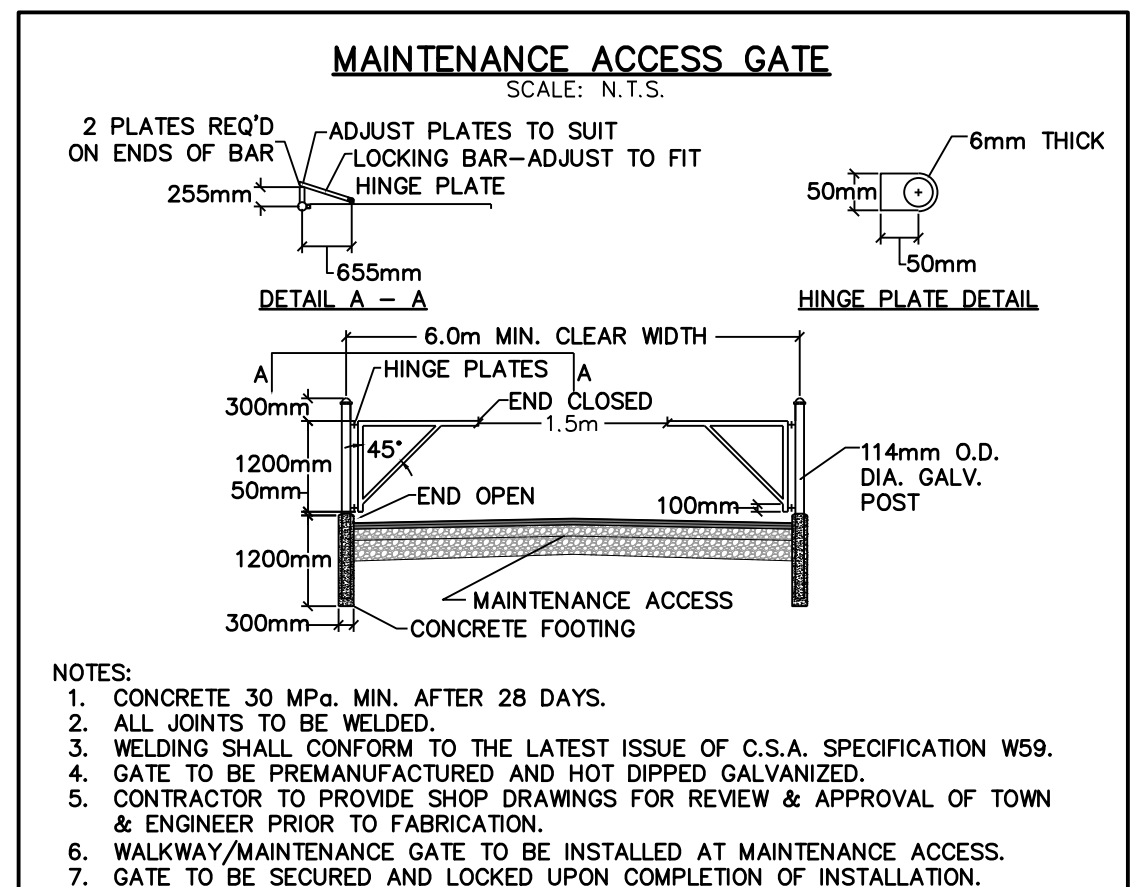

Material should be compacted to minimum 95% SPMD. Two lifts 150 mm thick. per GEI, Geotechnical Consultant

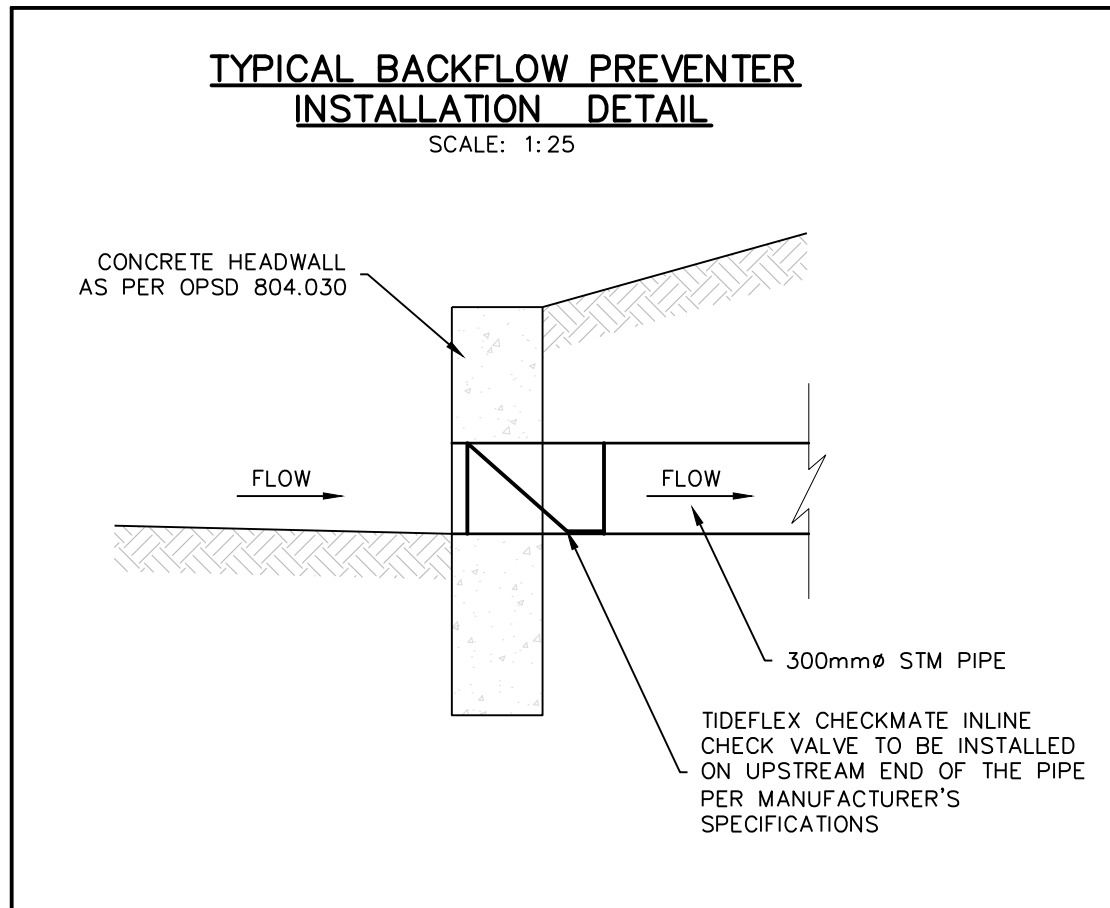

- THIS DRAWING IS THE EXCLUSIVE PROPERTY OF C.F. CROZIER & ASSOCIATES INC. AND THE REPRODUCTION OF ANY PART WITHOUT PRIOR WRITTEN CONSENT OF THIS OFFICE IS STRICTLY PROHIBITED.
- THE CONTRACTOR SHALL VERIFY ALL DIMENSIONS, LEVELS, AND DATUMS ON SITE AND REPORT ANY DISCREPANCIES OR OMISSIONS TO THIS OFFICE PRIOR TO CONSTRUCTION.
- THIS DRAWING IS TO BE READ AND UNDERSTOOD IN CONJUNCTION WITH ALL OTHER PLANS AND DOCUMENTS APPLICABLE TO THIS PROJECT.
- DO NOT SCALE THE DRAWINGS.
- ALL EXISTING UNDERGROUND UTILITIES TO BE VERIFIED IN THE FIELD BY THE CONTRACTOR PRIOR TO CONSTRUCTION.

TEMPORARY BENCHMARKS
TBM#1 - ELEVATIONS HEREON ARE GEODETIC AND ARE REFERRED TO A SPIKE IN HYDRO POLE ON GREY ROAD 19 SOUTH OF CRAIGLEITH ROAD HAVING AN ELEVATION OF 222.88 METRES.

TOPOGRAPHIC SURVEY COMPLETED BY ZUBEK, EMO, PATTEN AND THOMSEN LTD. O.L.S., DATED MARCH 2006.

No.	ISSUE	DATE: MM/DD/YYYY
0	ISSUED FOR 1st SUBMISSION	10/05/2018
1	ISSUED FOR 2nd SUBMISSION	09/17/2020
2	ISSUED FOR 3rd SUBMISSION	05/14/2021
3	ISSUED FOR 4th SUBMISSION	03/23/2022
4	ISSUED FOR 5th SUBMISSION (PARTIAL)	10/26/2022
5	ISSUED FOR 6th SUBMISSION	11/23/2022
6	ISSUED FOR 6th SUBMISSION (SWMFs ONLY)	03/29/2023
7	ISSUED FOR 6th SUBMISSION	04/20/2023

This Drawing is For INFORMATION ONLY
This Drawing should not be redistributed beyond the intended recipient

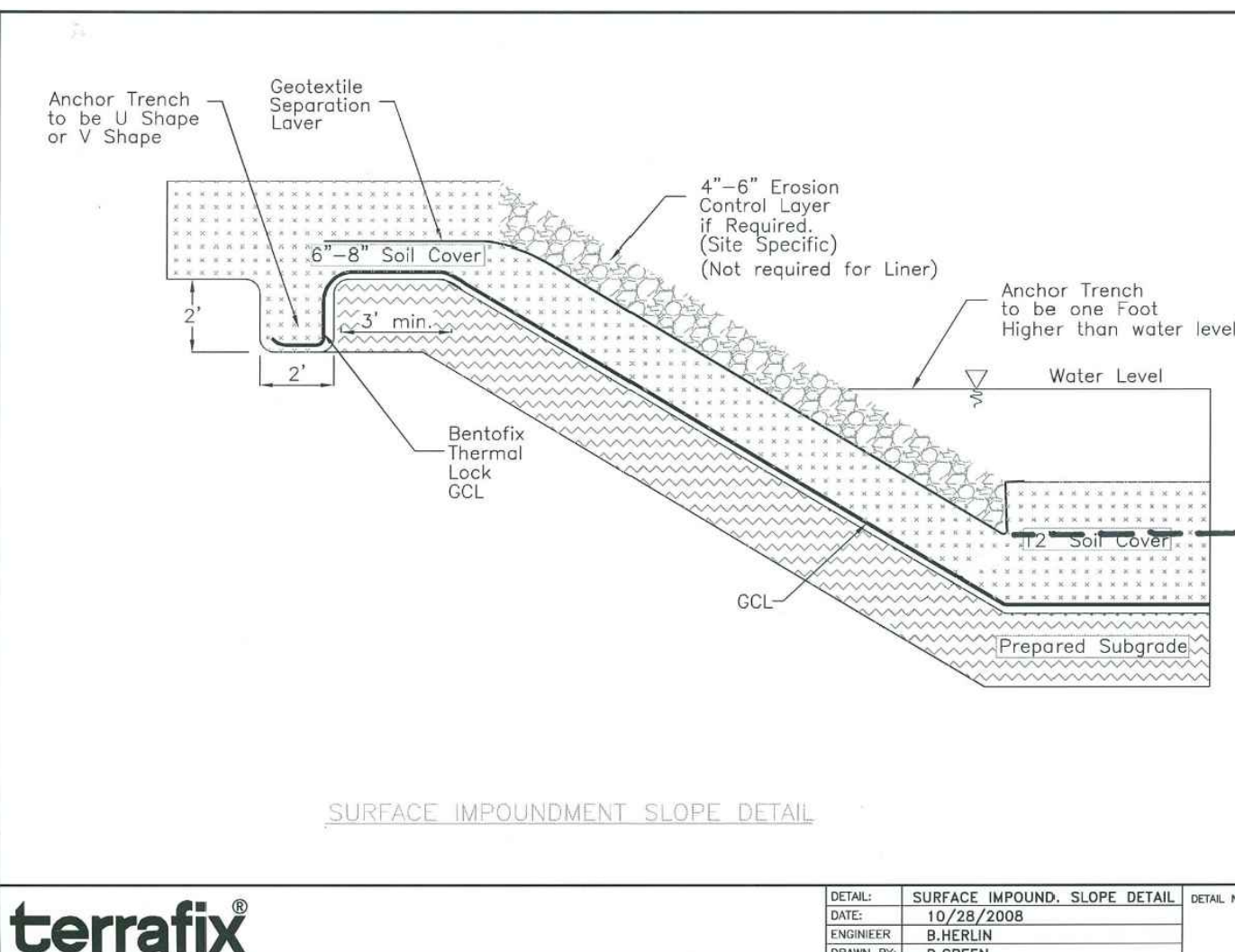
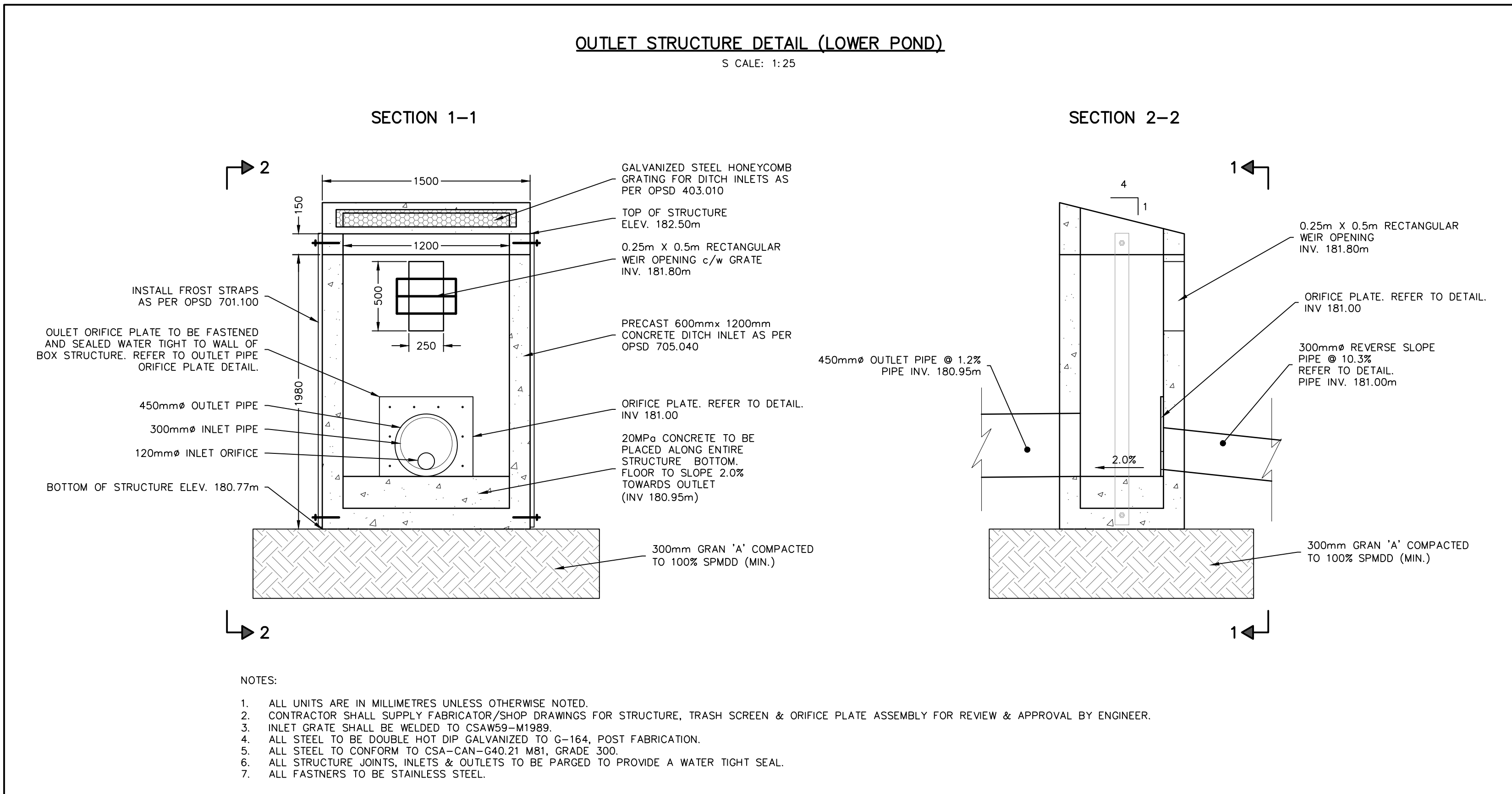

Project
PARKBRIDGE CRAIGLEITH
THE TOWN OF THE BLUE MOUNTAINS

Drawing
STORMWATER MANAGEMENT FACILITY 2 (LOWER POND) DETAILS



ADMIRAL BUILDING
1 FIRST STREET, SUITE 200
COLLINGWOOD, ON, L9Y 1A1
705-446-3510 T
705-446-3520 F
WWW.CROZIER.CA
INFO@CROZIER.CA

Drawn By	L.W.	Design By	L.W.	Project	1046-4031
Check By	R.W.	Check By	J.P.	Scale	AS SHOWN
				Drawing	C109.C